



Women's Campout

North Carolina Museum of Art

Saturday, November 6—Sunday, November 7, 2021

Complete the Registration Form and Waiver below, return it to us, and purchase your admission tickets by Friday, October 29.

CAMPOUT AND SCHEDULE INFORMATION

PARTICIPANTS

This is an adult-oriented outdoor event open to all self-identifying women ages 16 and up. No previous camping experience is necessary! Minors under 18 must be accompanied by a parent, guardian, or other responsible adult. ***Each individual participant must be preregistered, and every camper must have a ticket by October 29.***

For questions, contact the Manager of Park Programs: bryanne.senor@ncdcr.gov.

LOGISTICS

When: Saturday, November 6 at 5 pm through Sunday, November 7 at 11 am

Where: North Carolina Museum of Art
2110 Blue Ridge Road, Raleigh 27607
Museum Park, Festival Lawn behind East Building

Directions (see map below for details):

- From Blue Ridge Road, enter the Museum campus at Reedy Creek Road and immediately turn left. Follow signs for "Deliveries."
- Continue all the way around and down to the back of East Building (the brick building) into the Staff Parking Lot. Drive into the Staff Parking Lot to check in at the registration tent and unload your camping gear.
- Once you have checked in and unloaded, move your vehicle to the lower parking lots adjacent to the Staff Parking Lot. Then haul your gear to the camping area and set up!
- There are no assigned or reserved campsites. There will be plenty of space to choose your spot and make sure your camp is near family and friends.

NCMA Women's Campout

November 6-7, 5 pm-11 am

ARRIVE BY 5:30 pm

2110 Blue Ridge Road, Raleigh

REGISTRATION TENT

- Arrive here and check in with a staff member **first**
- Unload gear in Staff Parking Lot, and then go park
- Haul gear to camping area

Drive all the way around and down to the Staff Parking Lot, following signs for "Deliveries."

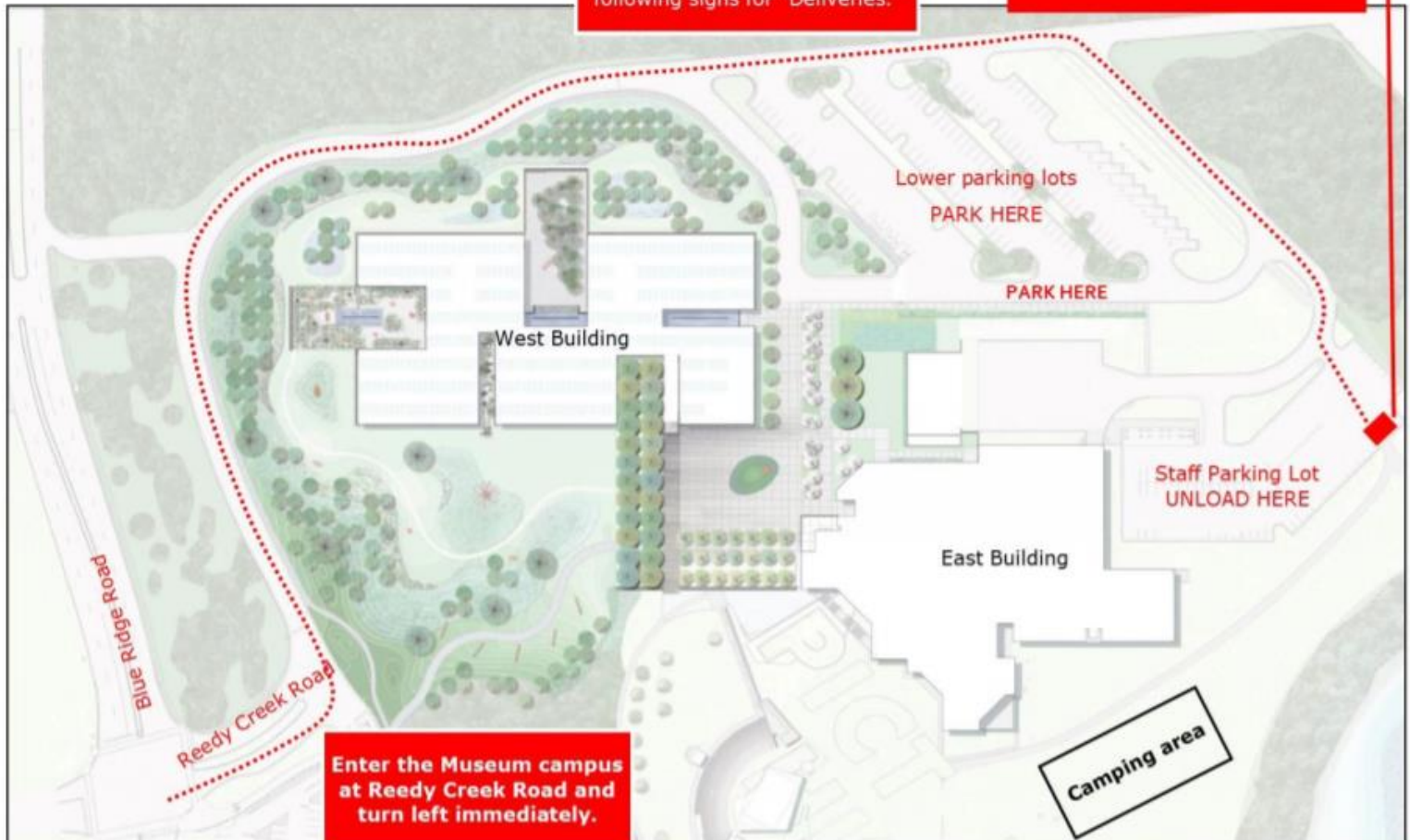

CAMPOUT SCHEDULE

- All activities are optional. Choose your own adventure!
- Lawn games will be set up throughout.
- The campout is held entirely outside; the Museum buildings will be closed.

Saturday

- 5 pm: Unloading and campsite setup. No early access. No cars in camping area. **Must arrive by 5:30 pm.**
- 6 pm: Dinner
- 7:30–8:30 pm: Facilitated intuitive dance session
- 9–10 pm: Astrology “campfire” chat
- Good night! Quiet hours are 11 pm to 6 am.

Sunday

- 7 am: Breakfast
- 8–11 am: Self-guided artmaking
- 8:30–9:30 am: Morning Yoga **OR** Tai Chi
- 9:30–10:30 am: Autumn Herb Walk
- 11 am: All camping equipment and personal belongings must be packed out and removed by this time. Thanks for coming!

FOOD

- Dinner on Saturday and breakfast on Sunday are included in your ticket. Meals will be provided from Catering Works in individual boxes for each camper, based on this Registration Form. **Fill out the form below completely so we can plan appropriately to provide you with the food of your choice.**
 - **Dinner menu:** House burger with caramelized onions *or* vegetarian black bean and queso burger served with a side salad, chips, and a cookie; water, iced tea, and hot cider for beverages. Can be made GF; mark this on your registration form if needed.
 - **Breakfast menu:** Vegetable frittata served with bacon, tater tots, and fruit cup (all GF); water, coffee, and hot tea for beverages. Can be made vegetarian; mark this on your registration form if needed.
- In addition to these provided meals, you may bring your own food and nonalcoholic beverages, as well as coolers, plastic storage containers, and other outdoor eating supplies. However, cooking on-site and fires are prohibited. No glass containers.

RESTROOMS

The outdoor restrooms are located in a concrete hallway near the Amphitheater, just a short walk from the camping lawn. They have sinks and toilets and will be open throughout the campout. Bring your own soap, toiletries, and towel.

TRASH

Please help keep the NCMA beautiful! Put trash and recycling in the labeled containers before you turn in for the night and before leaving on Sunday.

WEATHER

Unless the weather forecast looks dangerous, the campout will go on. Refunds are issued only if the NCMA cancels. Please prepare appropriately for the forecasted weather as well as the unexpected. We will send an email the week of the campout with any weather updates and ideas for how best to prepare.

WHAT TO PACK

- Refillable water bottle or cup and tumbler or mug for hot beverages
(Cups and water bottles will not be provided to reduce waste.)
- Tent with rainfly
- Ground cover/tarp
- Sleeping bag
- Sleeping pad/air mattress with portable inflater *(Access to power outlets is limited.)*
- Pillow
- Blanket(s)
- Raincoat and rain gear
- Warm jacket and layers
- Toiletries, hand sanitizer
- Washcloth or small towel
- Change of clothes
- Walking shoes
- Headlamp/flashlight
- Tent lantern
- First aid kit
- Camping chair
- Small wagon for toting supplies to and from campsite
- Binoculars
- Camera
- Yoga mat
- Portable battery charger for phone/electronics *(Access to power outlets is limited.)*
- An adventurous spirit

WHAT TO LEAVE AT HOME

- Alcohol
- Pets
- Camping stove, firewood, lighters; anything with an open flame
- Glass containers

RULES AND PROHIBITIONS

- No indoor access; the Museum buildings will be closed throughout the campout.
- Adults are responsible for themselves and the children with them. Because of risks of injury associated with the outdoor premises, including the varied landscaping, the pond, and the woods, children must be supervised at all times.
- Participants should behave in a courteous and safe manner with respect to the natural areas, artworks, and other participants.
- Smoking and vaping are permitted only in one designated area near the main Amphitheater entrance, about 0.1 mile from the camping location.
- The following are prohibited: alcoholic beverages, glass containers, unlawful possession or use of drugs or any illegal substance, feeding wildlife, firearms and other weapons, grills, fire, camping stoves, open flames, motorized vehicles, drones, loud music, pets, swimming.
- The NCMA Foundation reserves the right to refuse entry to the event by any person and to direct any person to leave the event at any time.

EMERGENCIES

In case of an emergency, call NCMA Security at (919) 664-6788.

An NCMA staff member will be on-site facilitating the campout on Saturday from 5 to 10 pm and on Sunday from 7 to 11 am.

COVID-19 SAFETY

We are committed to offering a safe and meaningful way to gather for this outdoor experience. We will carefully adhere to all State guidelines that will be in place during the campout, if any, and follow best practices for reducing the spread of COVID-19.

The capacity of the campout is limited for this reason. Food will be provided in individual containers to campers, and shared materials for activities will be minimal. There will be ample opportunities for campers to create the experience they prefer in terms of contact and social engagement. Please attend responsibly by bringing your own gear, being prepared to adhere to any safety requirements, and by staying home if you are symptomatic.

REGISTRATION

To register, complete and submit the following Registration Form and Waiver and purchase a ticket for ***each camper*** by October 29. **No one will be admitted unless properly preregistered and ticketed.**

Registration Form and Waiver

North Carolina Museum of Art Foundation, Inc. ("NCMAF")
Women's Campout, November 6-7, 2021 ("Campout")

INSTRUCTIONS

- Please read all the event information above and registration details before registering.
- If camping in a family or friend group, you may fill out one Registration and Waiver Form together, providing contact information and meal choices for each camper. All group members must sign the Waiver and purchase a ticket.
- This completed Registration and Waiver Form must be submitted by Friday, October 29. Each camper must also purchase a ticket by this date.
- Submit via email to bryanne.senor@ncdcr.gov, drop off at Tickets and Membership during open hours (2110 Blue Ridge Road, Raleigh), or mail to Bryanne Senor, 4630 Mail Service Center, Raleigh, NC 27699.

CAMPER INFORMATION AND MEAL CHOICES (for each camper in group)

NAME: _____ PHONE NUMBER: _____

EMERGENCY CONTACT AND PHONE NUMBER: _____

EMAIL (This is how we will share important campout information; please use a valid address that you regularly check.) _____

DINNER: House burger **or** Black bean burger

No cheese

GF

BREAKFAST: Vegetarian/no bacon

NAME: _____ PHONE NUMBER: _____

EMERGENCY CONTACT AND PHONE NUMBER: _____

EMAIL (This is how we will share important campout information; please use a valid address that you regularly check.) _____

DINNER: House burger **or** Black bean burger

No cheese

GF

BREAKFAST: Vegetarian/no bacon

NAME: _____ PHONE NUMBER: _____

EMERGENCY CONTACT AND PHONE NUMBER: _____

EMAIL (This is how we will share important campout information; please use a valid address that you regularly check.) _____

DINNER: House burger **or** Black bean burger

No cheese

GF

BREAKFAST: Vegetarian/no bacon

NAME: _____ PHONE NUMBER: _____

EMERGENCY CONTACT AND PHONE NUMBER: _____

EMAIL (This is how we will share important campout information; please use a valid address that you regularly check.) _____

DINNER: House burger **or** Black bean burger

No cheese

GF

BREAKFAST: Vegetarian/no bacon

NAME: _____ PHONE NUMBER: _____

EMERGENCY CONTACT AND PHONE NUMBER: _____

EMAIL (This is how we will share important campout information; please use a valid address that you regularly check.) _____

DINNER: House burger **or** Black bean burger

No cheese

GF

BREAKFAST: Vegetarian/no bacon

NAME: _____ PHONE NUMBER: _____

EMERGENCY CONTACT AND PHONE NUMBER: _____

EMAIL (This is how we will share important campout information; please use a valid address that you regularly check.) _____

DINNER: House burger **or** Black bean burger

No cheese

GF

BREAKFAST: Vegetarian/no bacon

WAIVER

Signatures required at end of form.

ASSUMPTION OF RISK, RELEASE AND DISCHARGE, COVENANT NOT TO SUE

I/we understand participation in the Campout involves inherent risks of personal physical or emotional injury, death, and damage to property. THOSE RISKS ARISE FROM, AMONG OTHERS, OUTDOOR PHYSICAL ACTIVITIES; CONTACT WITH OTHER PEOPLE; EXPOSURE TO FIRES, GRILLS, PLANTS, WATER, WOODS, AND WILDLIFE (INCLUDING ANIMALS, BIRDS, INSECTS, AND REPTILES); SLIPPERY GROUNDS AND PATHS; WATER FEATURES; AND NATURAL CONDITIONS (INCLUDING WIND, RAIN, AND STORMS).

I/we further understand that, despite safety precautions, the NCMF, the NCMA, and the State of North Carolina, separately or together, cannot and are not undertaking to guarantee the safety of any participant.

I/we also recognize that learning and following the rules for the Campout, and the instructions of the camp staff, will help me/us reduce the risks of injury.

I/we and the minor children identified in this Registration Form are physically and emotionally capable of participating in the Campout and that, to the best of our knowledge and belief, such participation will not exacerbate any physical or emotional disease or condition.

My/our participation in the Campout is purely voluntary. In consideration of permitting me/us to participate in the Campout, I/we agree as follows:

1. **ASSUMPTION OF RISK:** I/WE VOLUNTARILY ACCEPT AND ASSUME ALL RISKS THAT COULD RESULT IN INJURY, DEATH, OR PROPERTY DAMAGE DURING, ARISING OUT OF, OR RELATING TO THE CAMP OUT. I/WE ACCEPT AND ASSUME THESE RISKS FOR MYSELF/OURSELVES AND AS PARENTS/GUARDIANS OF AND ON BEHALF OF THE MINOR CHILDREN IDENTIFIED IN THIS REGISTRATION FORM.
2. **RELEASE, DISCHARGE, COVENANT NOT TO SUE, INDEMNITY:** I/WE HEREBY RELEASE, DISCHARGE, COVENANT NOT TO SUE, AND INDEMNIFY THE NCMF, THE NCMA, AND THE STATE OF NORTH CAROLINA, AND THEIR

