

NEW LANDSCAPE

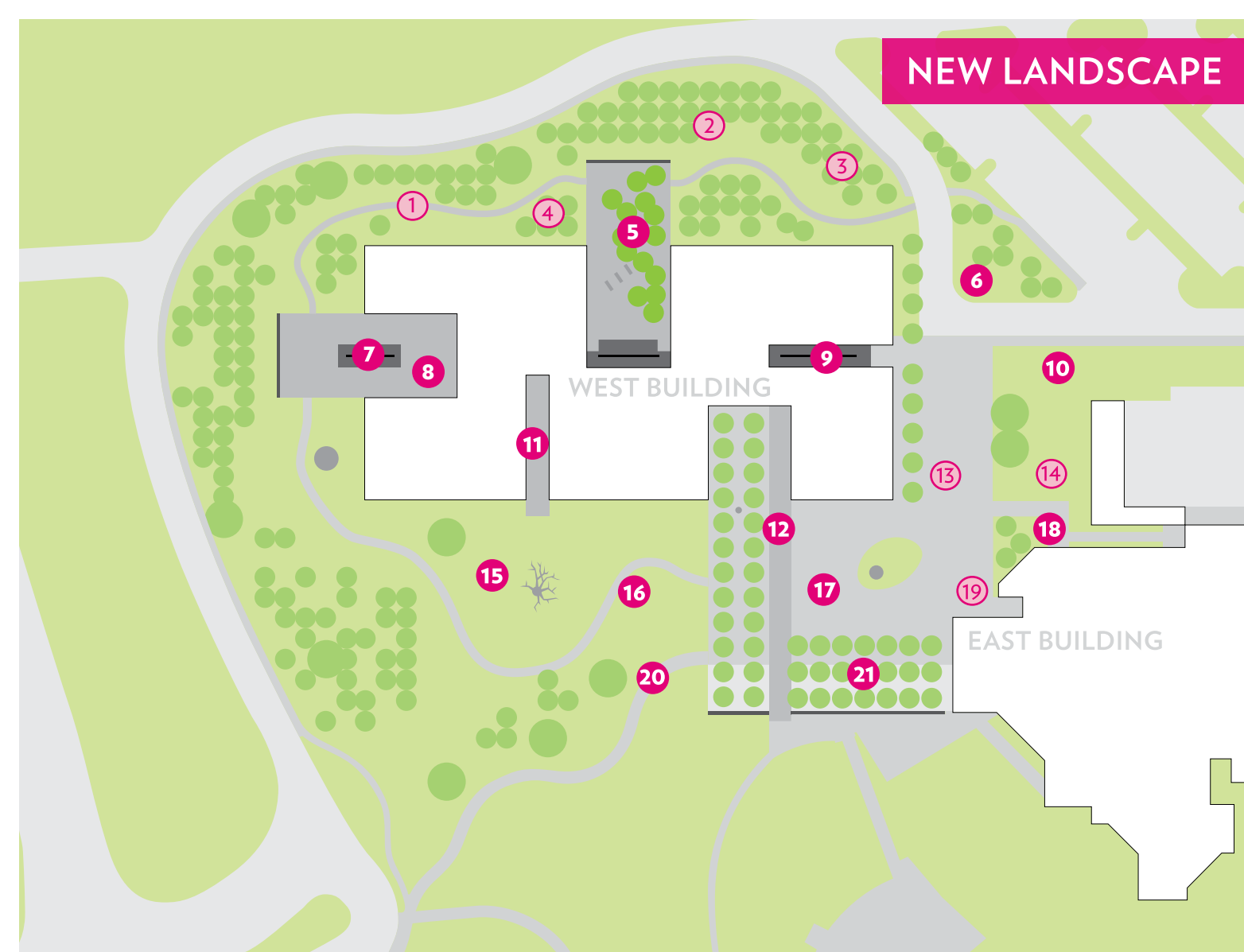

- 1 North Garden Walk \$150,000
- 2 North Grove \$150,000
- 3 Rose Gardens (2) \$50,000
- 4 Rain Gardens (4) \$50,000
- 5 In honor of Lawrence J. Wheeler, Director, North Carolina Museum of Art, by a friend NORTH GARDEN
- 6 Kay and Bob Schoellhorn NORTHEAST GARDEN
- 7 In honor of Jean R. Rorke, given by Donald M. Rorke WEST POOL
- 8 Iris and B. Gerald Cantor Garden
- 9 Carolyn and Norman Banks EAST POOL
- 10 In memory of Anne Weatherspoon Phoenix EAST ENTRY GARDEN
- 11 In honor of Preston R. and F. Pauline Noble, given by Dr. and Mrs. Shaler Stidham Jr. LINEAR GARDEN
- 12 Gordon Hanes WEST BUILDING ENTRY
- 13 East Walk \$150,000
- 14 Education Courtyard \$150,000
- 15 In honor of Mary D. B. T. Semans SOUTH GARDEN
- 16 Blue Cross and Blue Shield of North Carolina SCULPTURE WALK
- 17 Gipson Plaza
- 18 In honor of The Sir Walter Cabinet EDUCATION ENTRY WALK
- 19 East Building Entry \$150,000
- 20 In honor of Peggy R. Fain SOUTH WALK
- 21 In honor of Georgia and William A. Davis Jr., given by W. Kent Davis PLAZA GROVE

PARK



- 1 Pond Benches (8) \$25,000
- 2 Pond \$500,000
- 3 Pond Loop Trail \$100,000
- 4 Park Benches (6) \$25,000
- 5 The Hill \$150,000
- 6 The Grove \$100,000
- 7 Picnic Tables (6) \$25,000
- 8 Upper Meadow \$100,000
- 9 Lower Meadow \$100,000
- 10 West Woods \$100,000
- 11 Cloud Chamber Footbridge \$25,000
- 12 South Woods \$100,000
- 13 East Woods Footbridge \$50,000
- 14 East Woods \$100,000
- 15 Park Service Center \$50,000

Electric Park Vehicles (3) \$50,000

OUR TRANSFORMATION
THE CAMPAIGN FOR THE
NORTH CAROLINA MUSEUM OF ART

SITE NAMING OPPORTUNITIES

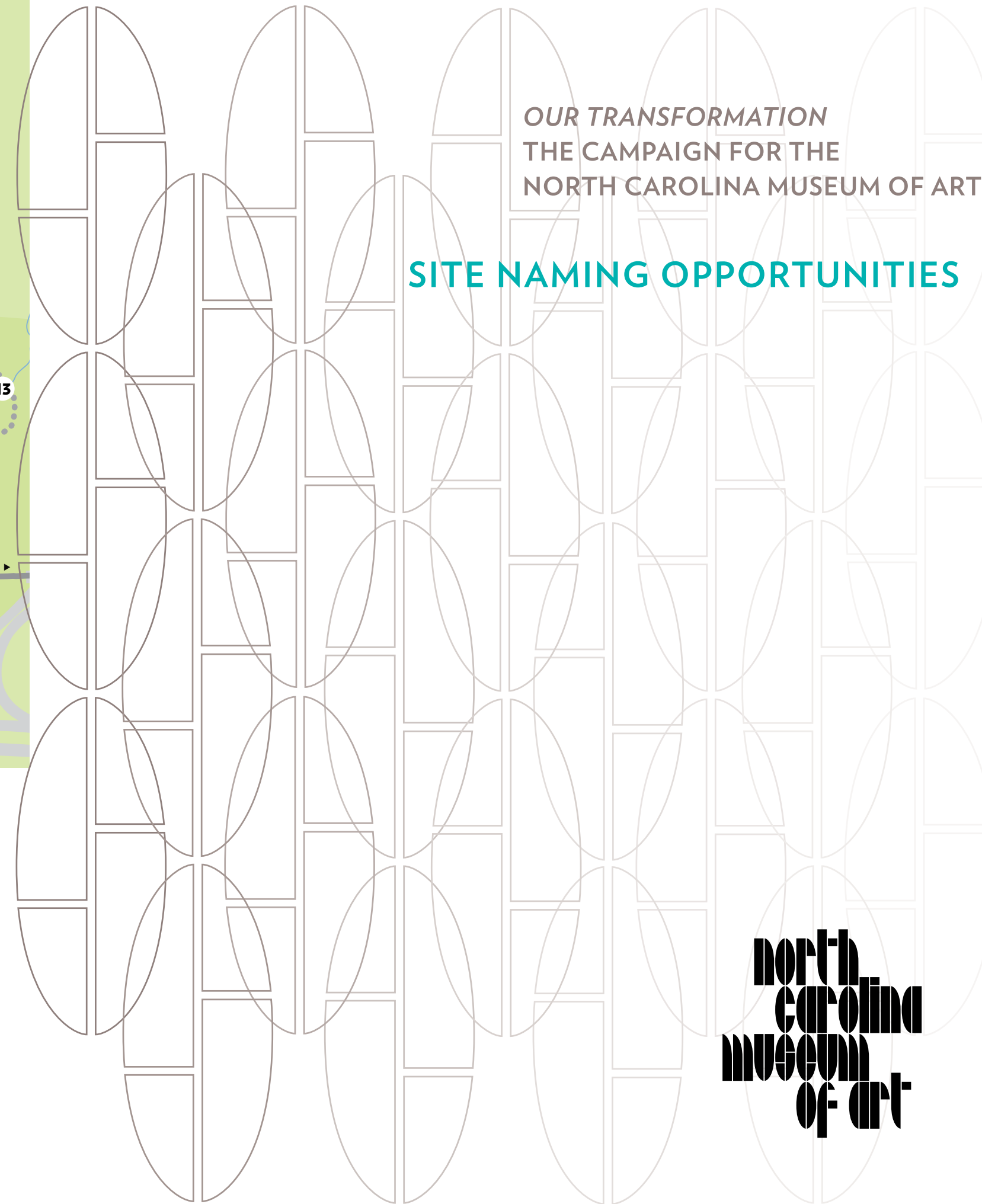

north
carolina
MUSEUM
of art

WEST BUILDING

EAST BUILDING

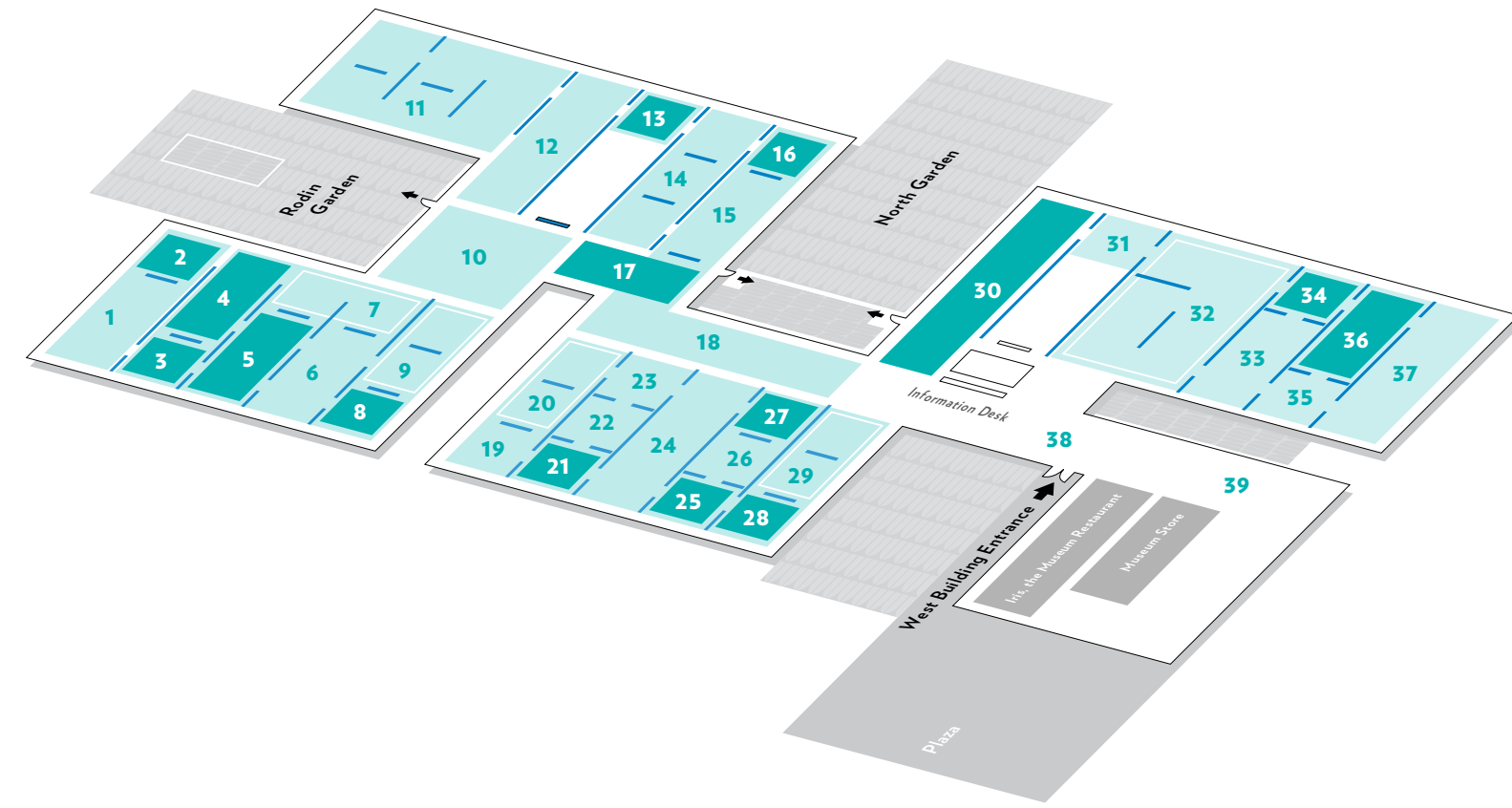

- 1 Abram and Frances Pascher Kanof Galleries
- 2 Focus Gallery \$350,000
- 3 18th to 19th Centuries European, "Animal" Gallery \$500,000
- 4 Impressionism \$1,000,000
- 5 18th to 19th Centuries European, "Mythology" Gallery \$1,000,000
- 6 Julia and Frank Daniels Galleries
- 7 Joan C. and Robert R. Huntley Galleries
- 8 17th to 18th Centuries European \$500,000
- 9 Charles E. and Pauline L. Hayworth Galleries
- 10 Iris and B. Gerald Cantor Court
- 11 Ann and Jim Goodnight Galleries
- 12 Thomas S. Kenan III Galleries
- 13 Ancient American \$350,000
- 14 SAS Galleries
- 15 Steve and Frosene Zeis Gallery
- 16 Classical \$500,000
- 17 Classical Court \$500,000
- 18 Steve and Frosene Zeis Court
- 19 William R. Valentiner Gallery
- 20 David R. Hayworth Galleries
- 21 17th-Century Flemish \$500,000
- 22 Virginia Camp Smith Gallery
- 23 Governor and Mrs. Luther H. Hodges Gallery
- 24 Samuel H. Kress Foundation Galleries
- 25 16th-Century Italian \$500,000
- 26 J. Sidney and Nancy Wallace Kirk Gallery
- 27 15th to 16th Centuries Northern European \$500,000
- 28 13th to 16th Centuries Italian \$500,000
- 29 Ron and Jeanette Doggett Galleries
- 30 African \$2,000,000
- 31 Marty Hayes and Michael Cucchiara Gallery
- 32 Mary and Jim Patton Galleries
- 33 Josie and Julian H. Robertson Jr. Galleries
- 34 Modern and Contemporary \$500,000
- 35 Fannie and Alan Leslie Gallery
- 36 Modern and Contemporary \$1,000,000
- 37 Allen and Marianne Mebane Galleries
- 38 The Belk Foundation LOBBY
- 39 The Dickson Foundation FOYER

LEVEL O

- Art Reference Library \$1,000,000
- Director's Suite \$250,000
- Boardroom \$100,000

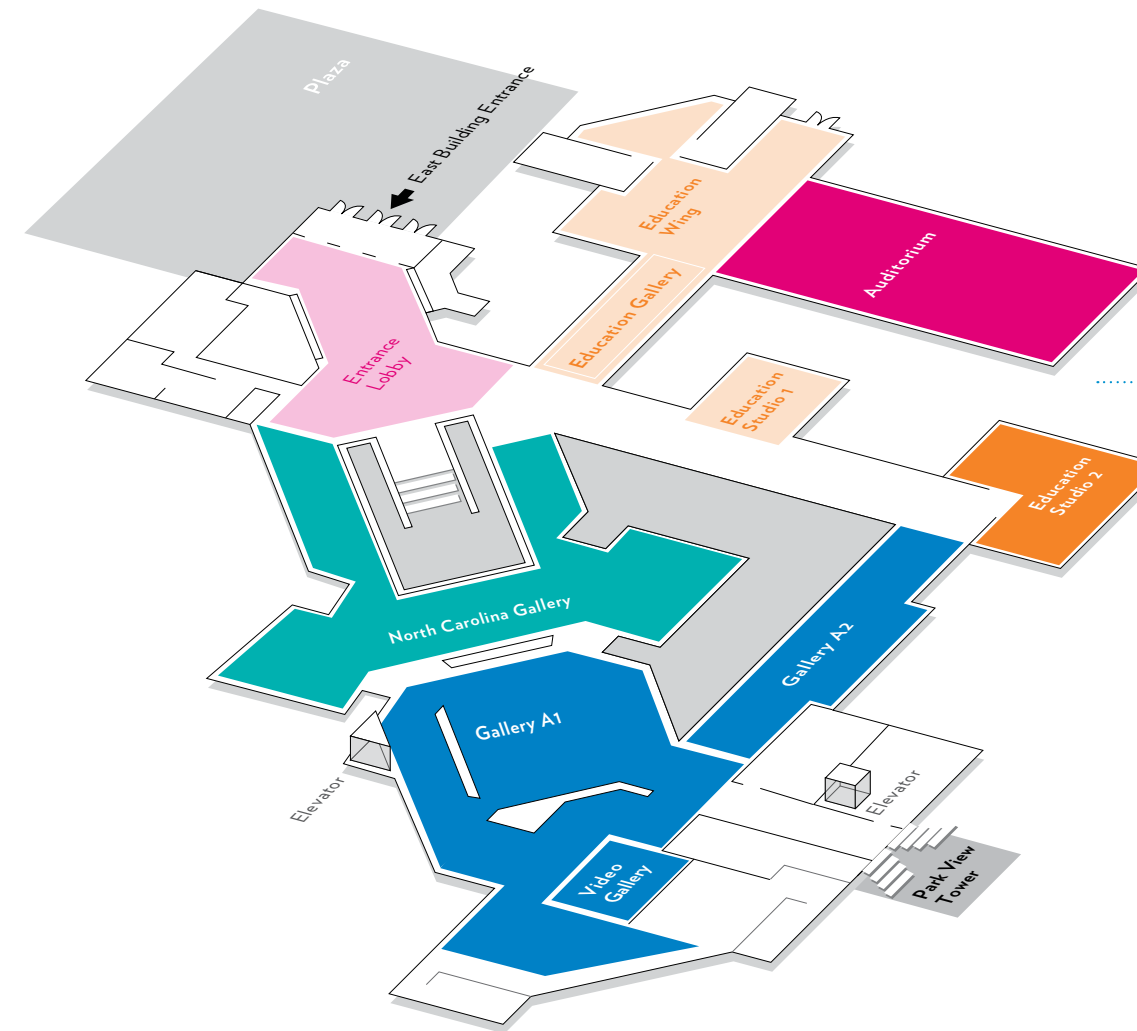
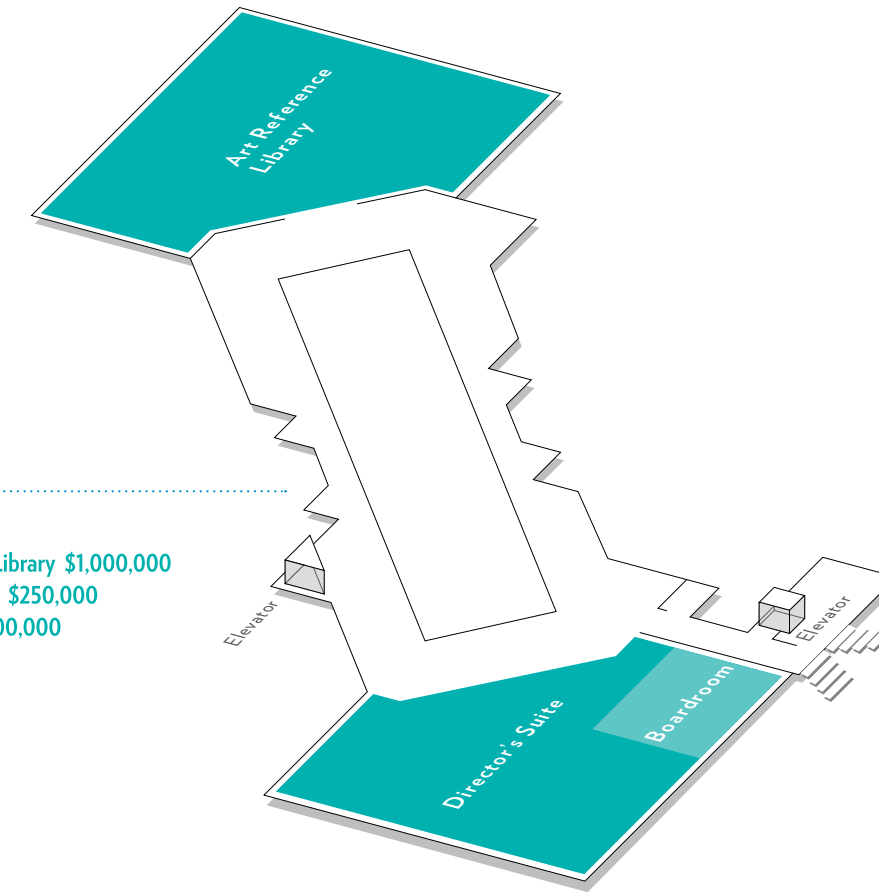

LEVEL A

- Wachovia Wells Fargo Foundation Lobby ENTRANCE LOBBY
- Nancy Susan Reynolds Education Wing EDUCATION WING
- NC GlaxoSmithKline Foundation Gallery EDUCATION GALLERY
- Auditorium \$1,000,000
- Progress Energy EDUCATION STUDIO 1
- Education Studio 2 \$100,000
- North Carolina Gallery \$500,000
- Gallery A1 \$500,000
- Gallery A2 \$500,000
- Video Gallery \$100,000
- Park View Tower \$250,000

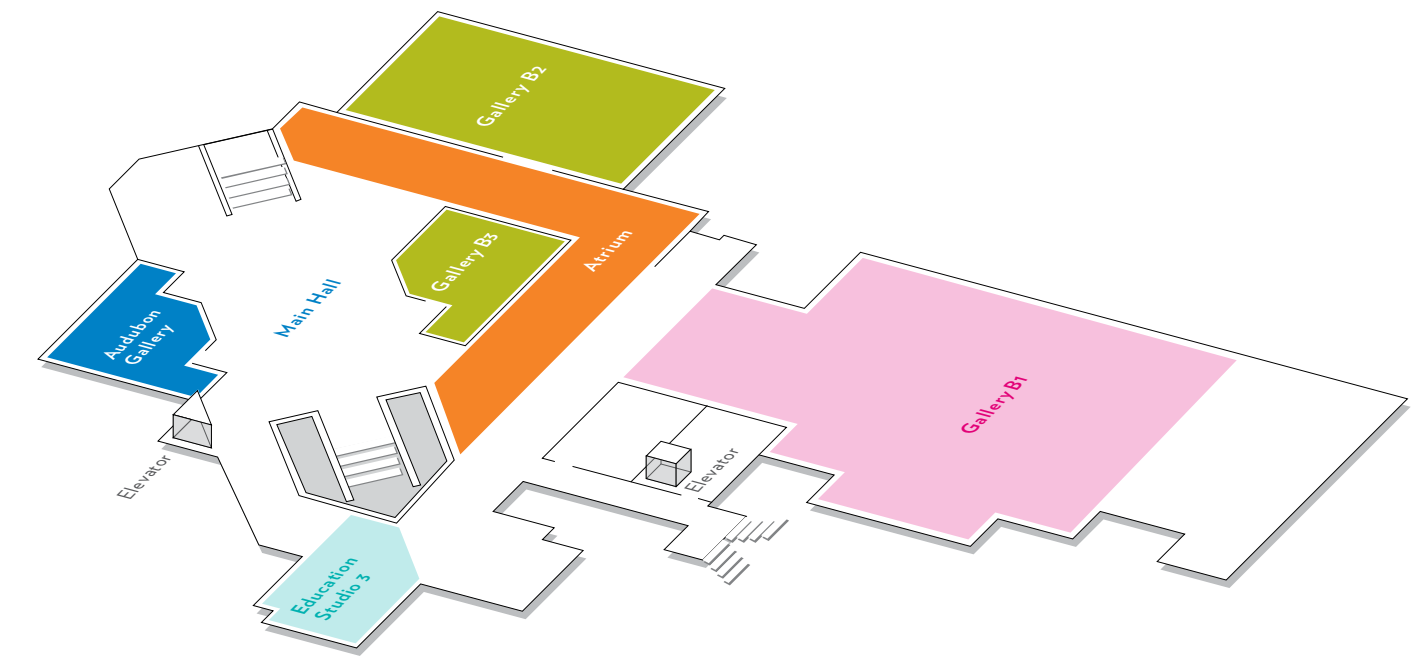

LEVEL B

- Atrium \$250,000
- Main Hall \$500,000
- Meymandi Exhibition Gallery GALLERY B1
- Gallery B2 \$500,000
- Gallery B3 \$150,000
- Audubon Gallery \$200,000
- Mary and Watts Hill EDUCATION STUDIO 3

LEVEL C

- In memory of Elizabeth Gotham PATIO
- Event Space 1 \$250,000
- Event Space 2 \$250,000
- Conference Room \$250,000
- Green Room \$100,000

